

**REALCOLD**

# Hydraulic Power Pack

Model RC100



**PARTS DIAGRAM**





## RC100-50 HYDRAULIC POWER PACK

ITEM NO.	QTY.	PART NO.	DESCRIPTION
1	1	180-ND86B	COUPLING, ELECTRIC MOTOR HALF
2	1	180-ND86P2	COUPLING, HYDRAULIC PUMP HALF
3	1	180-QVV-F06	HYDRAULIC COUPLER FEMALE
4	1	180-QVV-M06	HYDRAULIC COUPLER MALE
5	1	180-R82	COUPLER DAMPER
6	1	180-RV3A-10-S-O-36	PRESSURE RELIEF VALVE
7	1	180-SNA076B-S-T-12-O60	LEVEL GAUGE WITH THERMO SWITCH
	1	180-TS-SNA-O-60	THERMO SWITCH
8	1	180-SMK20-R1-4PD	TEST COUPLING
9	2	180-STDO1630	TUBE STAND OFF 16 X 30
10	1	300-2004642	HYDRAULIC PUMP
	1	300-42520000	SHAFT KEY
	1	300-62046601	HYDRAULIC PUMP SEAL KIT
11	1	300-31-4	CETOP3 MANIFOLD
12	1	300-CF55-GC	HYDRAULIC TANK ASSEMBLY
13	1	300-DG18V3-8C-V-P-61	HYDRAULIC VALVE
	1	300-858995	HYDRAULIC VALVE SEAL KIT
14	1	300-KS810	8 x 10mm KEY
15	1	300-LS300	BELLHOUSING FR132
16	1	300-LS300-CR	BELLHOUSING CENTERING RING
17	1	300-LS300-GASK	BELLHOUSING GASKET
18	1	300-M34005504SLA	ELECTRIC MOTOR 5.5KW
19	1	300-MPF100	HYDRAULIC FILTER ASSEMBLY
	1	300-MPF100-P10	FILTER ELEMENT
20	1	300-TR2-B-S10	HYDRAULIC TANK FILLER
21	1	800-2-MP-4	4mm RED/GREEN TWINLINE
22	1	800-HYD08-5M	HYDRAULIC HOSE KIT 1/2" 5M
23	2	800-CSM1045-304	CAP SCREW M10x45 304
24	2	800-FWM10-304	M10 FLAT WASHER
25	2	800-SWM10-304	SPRING WASHER M10 304
26	1	900-10010-A	CONTROL BOARD ANTI-TIEDOWN

**RC100-50 HYDRAULIC POWER PACK**

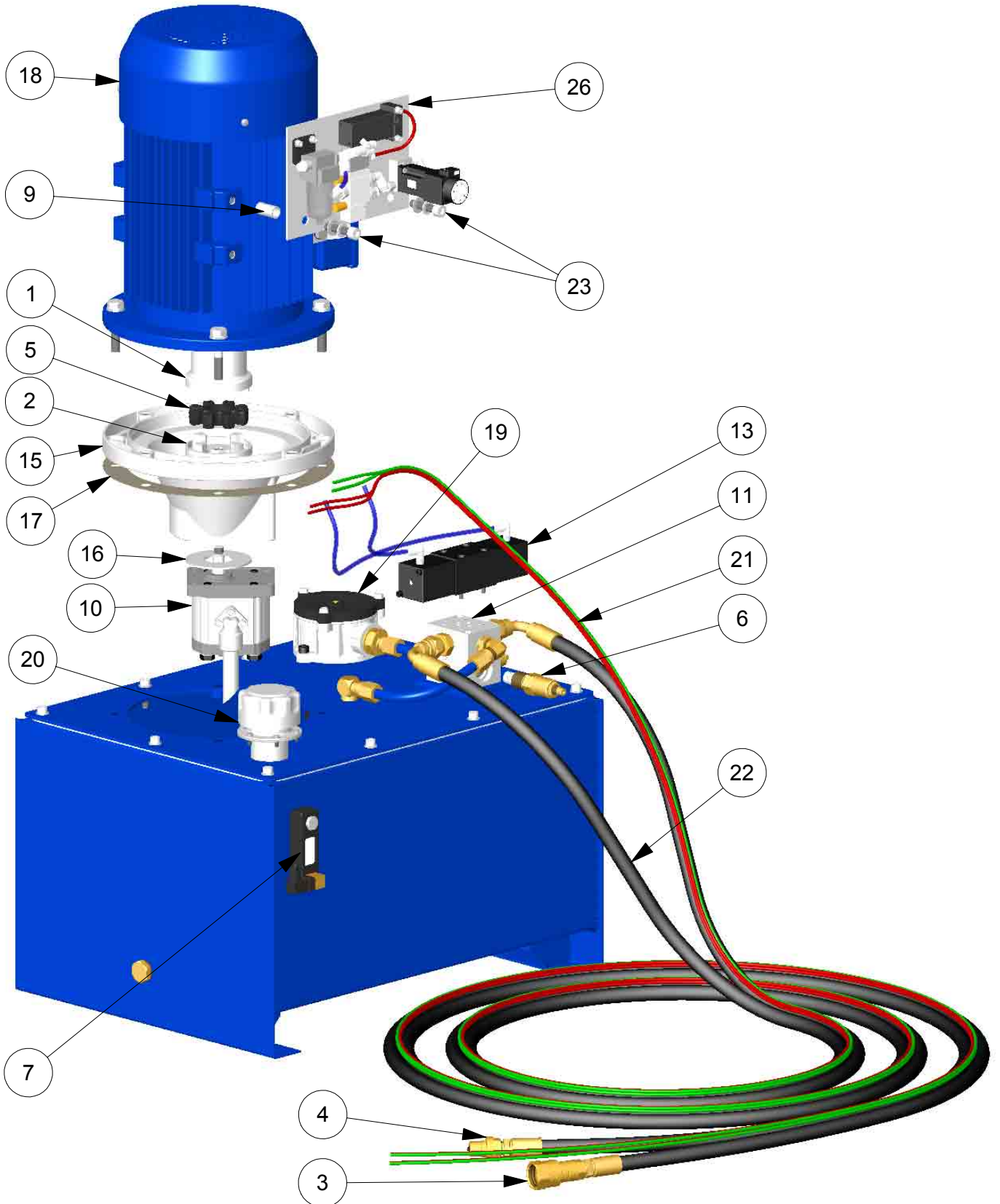



## RC100 CONTROL BOARD ANTI-TIEDOWN 900-10010-A

ITEM NO.	QTY.	PART NO.	DESCRIPTION
1	1	180-315202	1-8BSPP PORT PLUG
2	1	180-AF2000-02B	AIR FILTER
3	2	180-AN101-01	SILENCER, BRONZE, 1/8BSP
4	1	180-KQ2Y06-02S	BRANCH T 1-4BSPT 6mm
5	1	180-KQ2X04-06	BRANCH Y REDUCER
6	2	180-KQ2L06-02S	ELBOW PUSH FIT CONNECTOR
7	3	180-KQ2L06-01S	ELBOW PUSH FIT CONNECTOR
8	2	180-KQ2H06-02S	STRAIGHT CONNECTOR 6mm-1/4BSP
9	1	180-KQ2H04-01S	STRAIGHT CONNECTOR 4mm-1/8BSP
10	1	180-KQ2H06-01S	STRAIGHT CONNECTOR 6mm-1/8BSP
11	1	190-2781580101	PNEUMATIC LOGIC VALVE
12	1	190-7097K04450	TIMER BASE
13	1	190-81532001	PNEUMATIC LOGIC VALVE BASE
14	1	190-PRTF10	PNEUMATIC TIMER
15	1	190-SYA7120-02	5/2 PNEUMATIC VALVE
16	2	800-CSM412-304	CAP SCREW M4x12 304
17	2	800-CSM416-304	CAP SCREW M4x16 304
18	2	800-CSM512-304	CAP SCREW M5x12 304
19	2	800-CSM535-304	CAP SCREW M5x35 304
20	4	800-FWM5-304	M5 FLAT WASHER
21	2	800-FWM4-304	M4 FLAT WASHER
22	4	800-SWM5-304	SPRING WASHER M5 304
23	2	800-SWM4-304	SPRING WASHER M4 304
24	1	800-TU0425-R	4mm POLYURETHANE HOSE RED
25	1	800-TU0604-BU	6mm POLYURETHANE HOSE
26	1	900-10010-1-A	CONTROL BOARD MOUNT PLATE

**RC100 CONTROL BOARD ANTI-TIEDOWN  
900-10010-A**

